



Maestro

Year	1997 – 2021
Designer	Gianfranco Frattini

With the precision and vivid identity that Gianfranco Frattini imbued in his work, the Maestro table was designed to conjure function and perfection in living spaces.

Today, in the new 1.5x1.5 meters square version and in the 2,5, 3 and 3.5 meters rectangular version, it becomes grander in its scale for modern entertaining needs, and more dramatic in its material impact, with black ash wood and dark stained walnut making dark silhouettes of the long, cantilevered wings of the table and its linear play of cutouts that recalls traditional Japanese architecture.

Dimensions

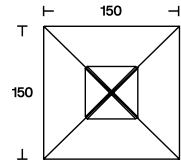
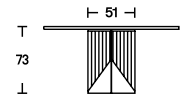

L 150
D 150
H 73

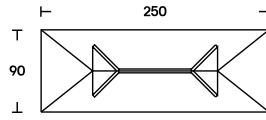
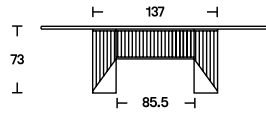

L 250
D 90
H 73

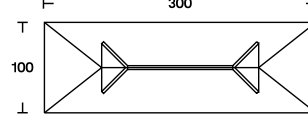
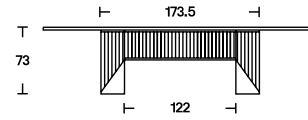

L 300
D 100
H 73

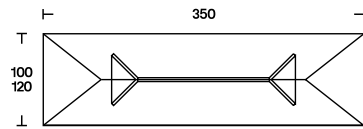
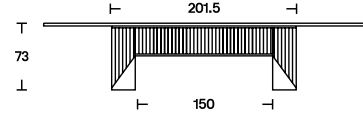

L 350
D 100 / 120
H 73

Finishes

Table base available in solid black ash wood or dark stained walnut.
The 30mm thick top of medium density wood fiber features an inlaid grain veneer.

Frame and top



Finishes legend

Black ash	ES58
Dark stained walnut	ES59
Bleached ash	ES62
